

**CL 010D**

Indossare guanti di protezione  
Wear protective gloves

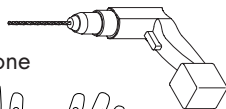

23 mm.

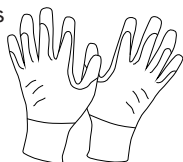

2 mm  
2,5 mm



ATTENZIONE!!!!

Tutte le operazioni di installazione e manutenzione richiedono l'ausilio di NR. 2 OPERATORI SPECIALIZZATI

WARNING!!!!

All installation and maintenance operations require 2 QUALIFIED WORKER

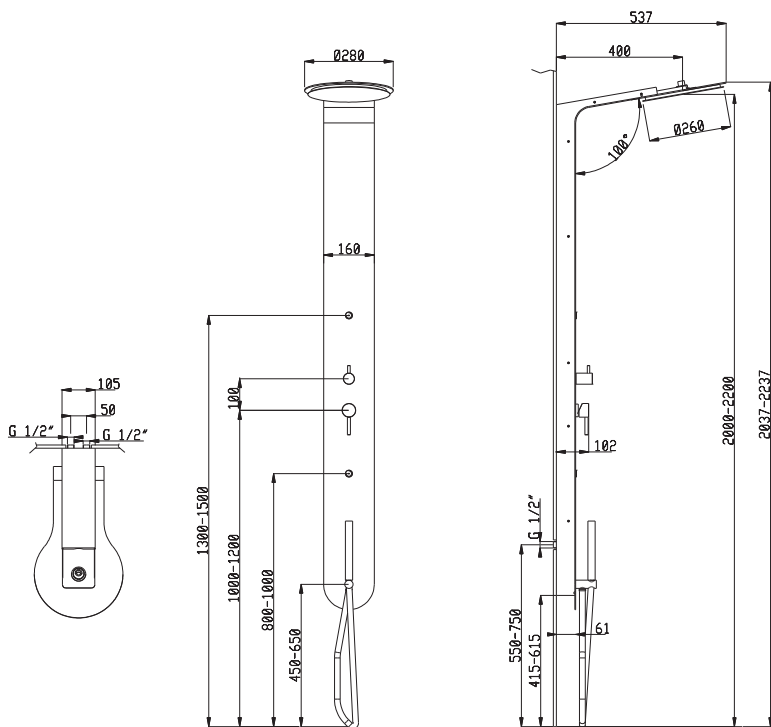

PRESA ACQUA  
WATER FEED

Posizionare 1 Trasformatore all'esterno della zona 2 (nella zona 3)  
Place the current transformer outside area 2 (inside area 3)

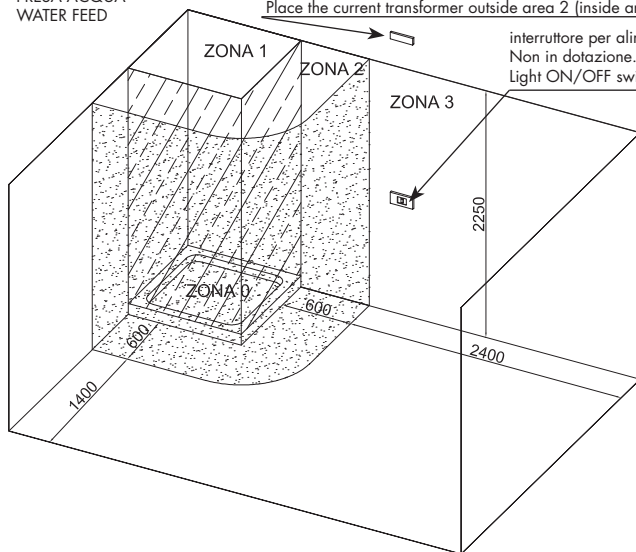

interruttore per alimentazione.  
Non in dotazione.  
Light ON/OFF switch. Not provided.

E' necessaria l'installazione di un interruttore ON/OFF sull'alimentazione del trasformatore.  
Require installation of control key for switch on/off lights on transformer power supply.



All'interno delle zone ZONA 0 - ZONA 1 - ZONA 2  
NON DEVE ESSERE MAI PRESENTE LA TENSIONE 220V  
ELECTRICAL CURRENT AT 220 V MUST NEVER BE PRESENT within areas 0 - 1 - and 2

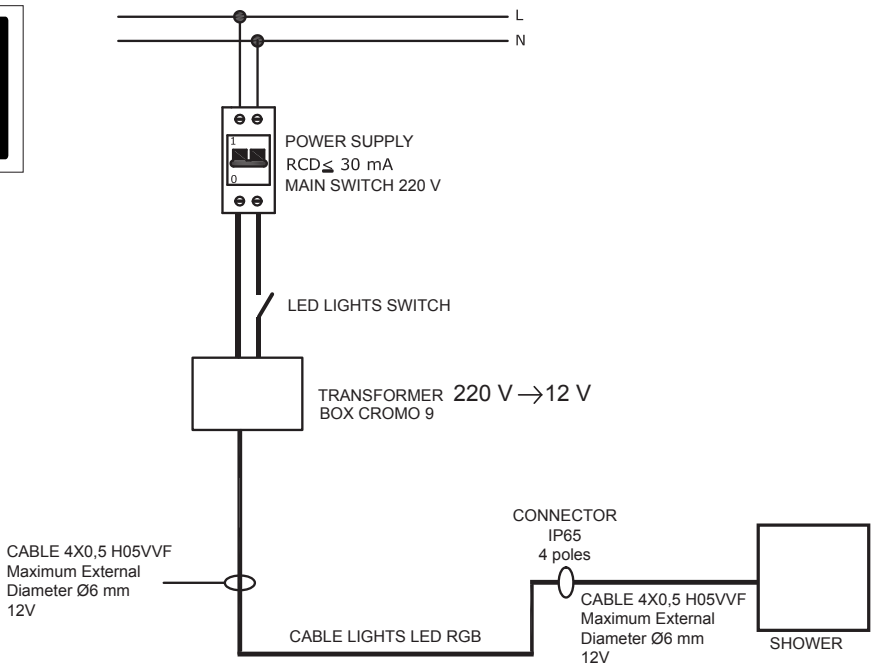
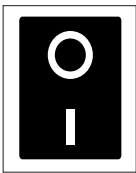
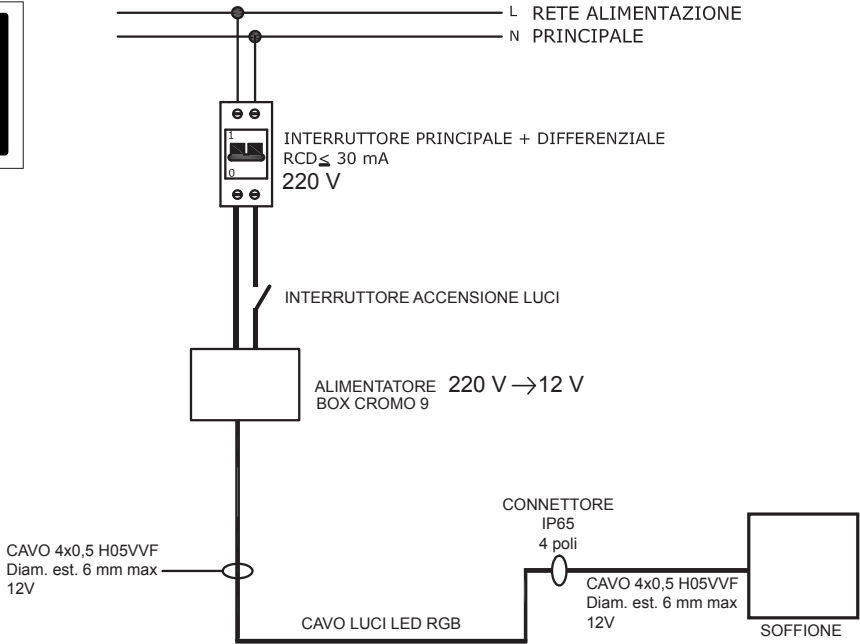
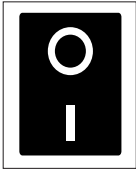

a

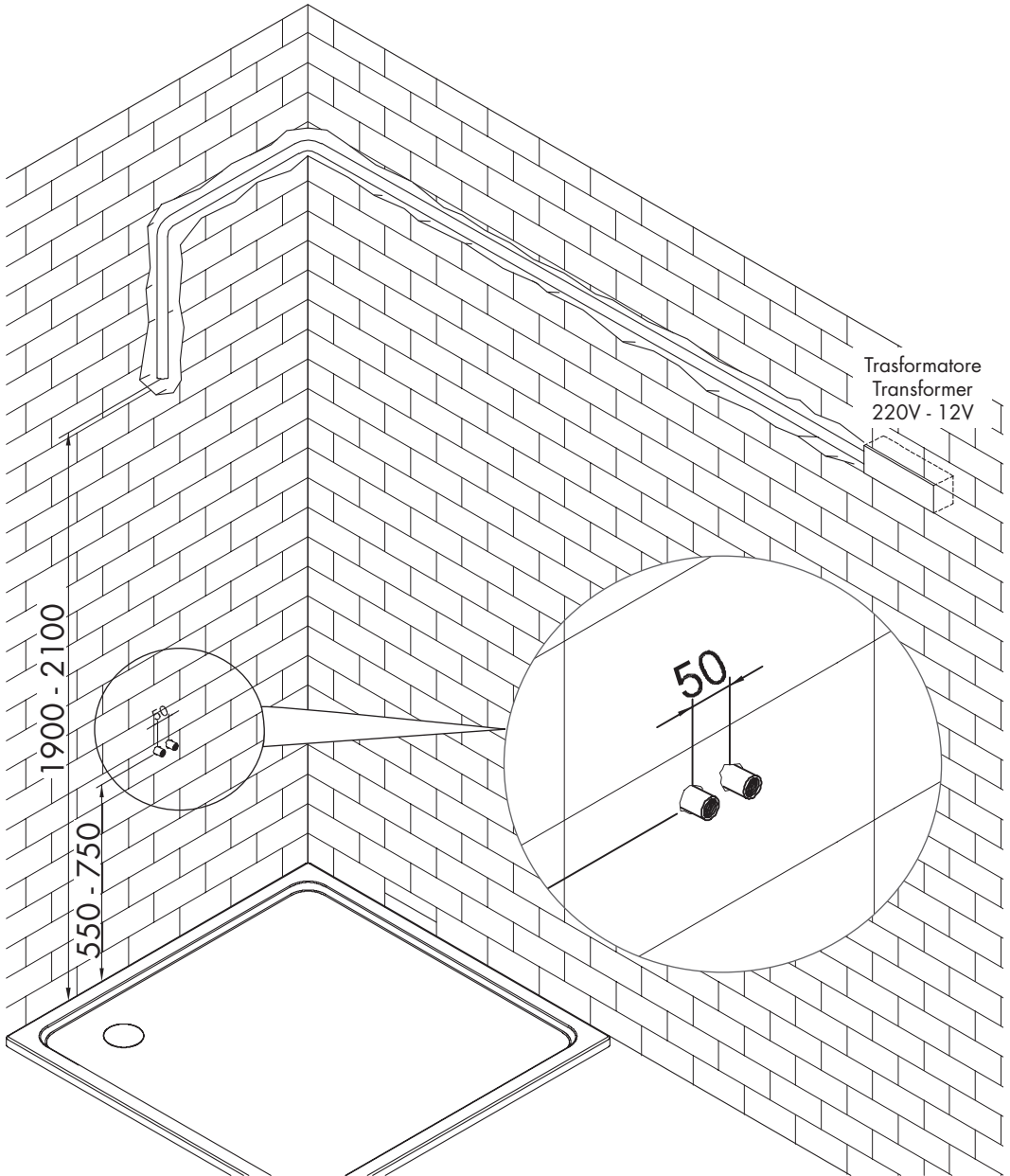

b

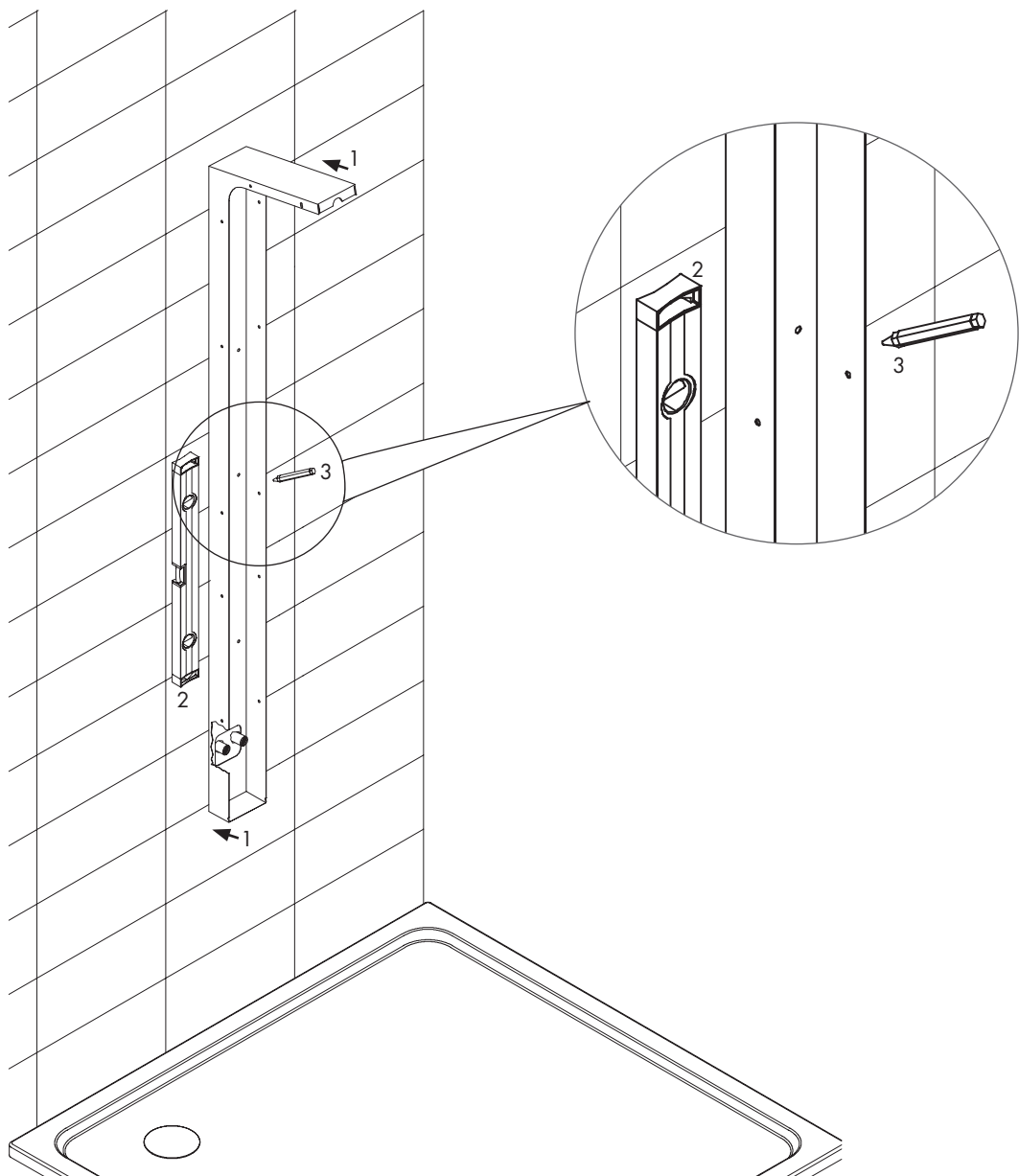

c

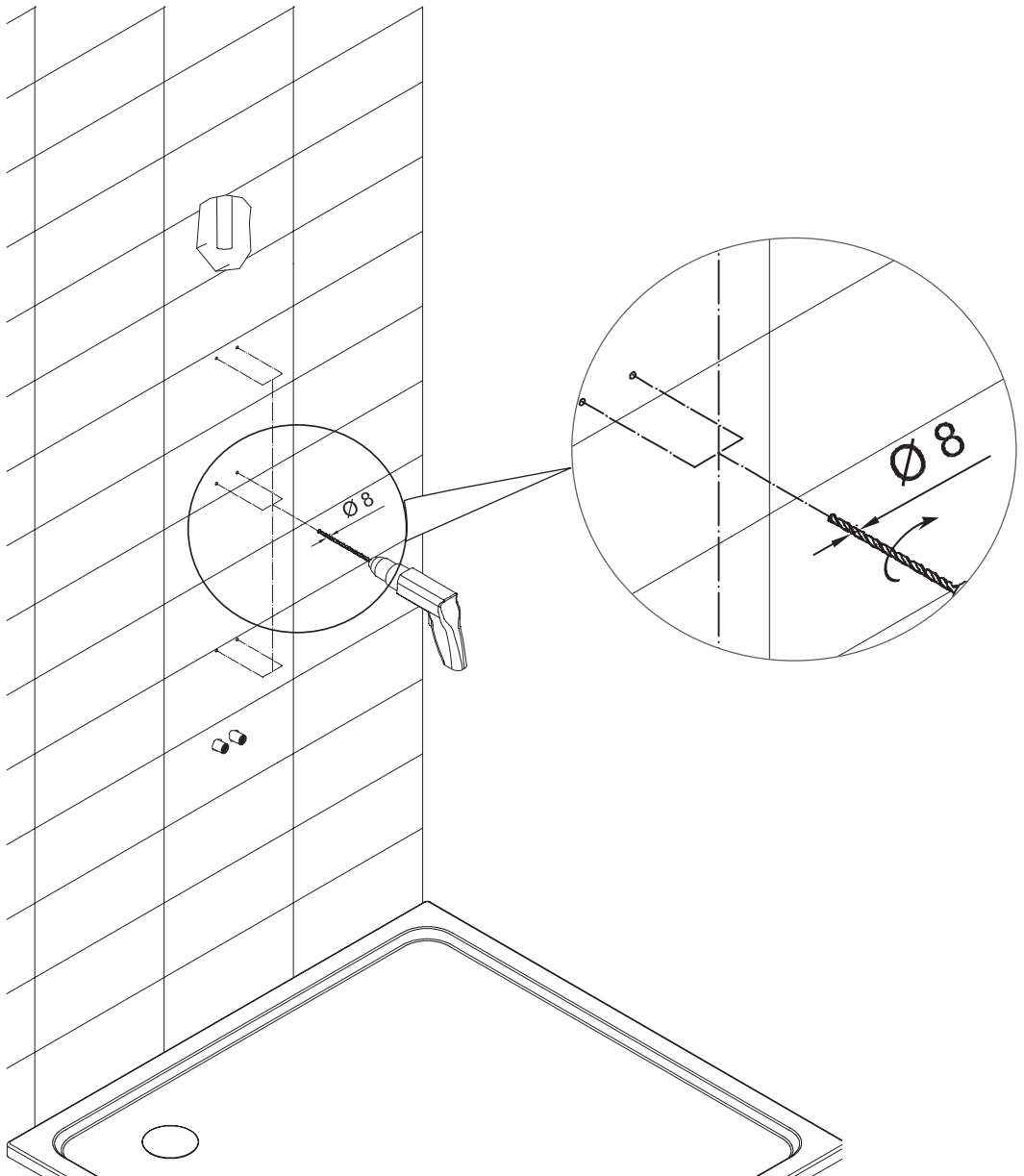

d

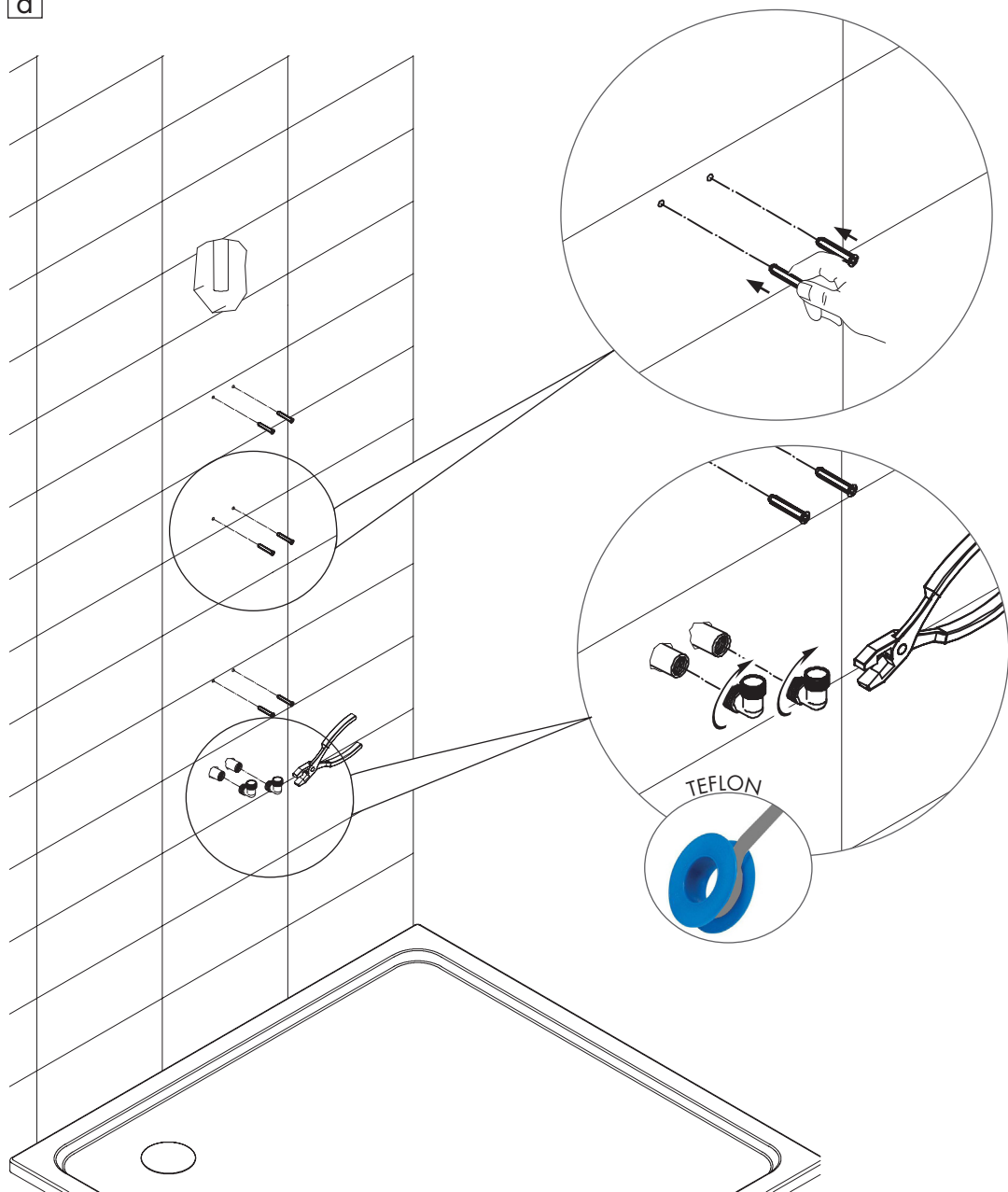



e

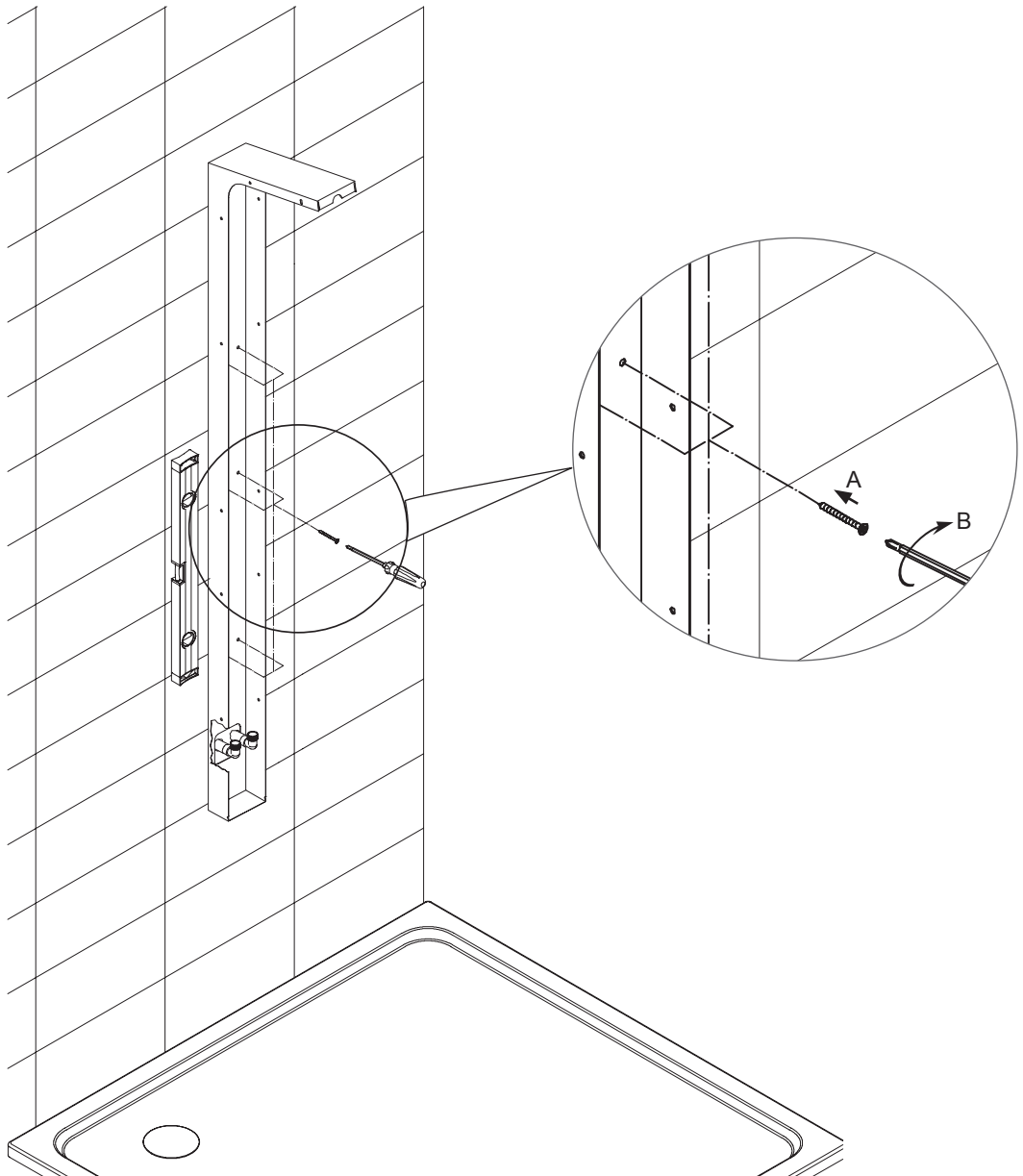

f

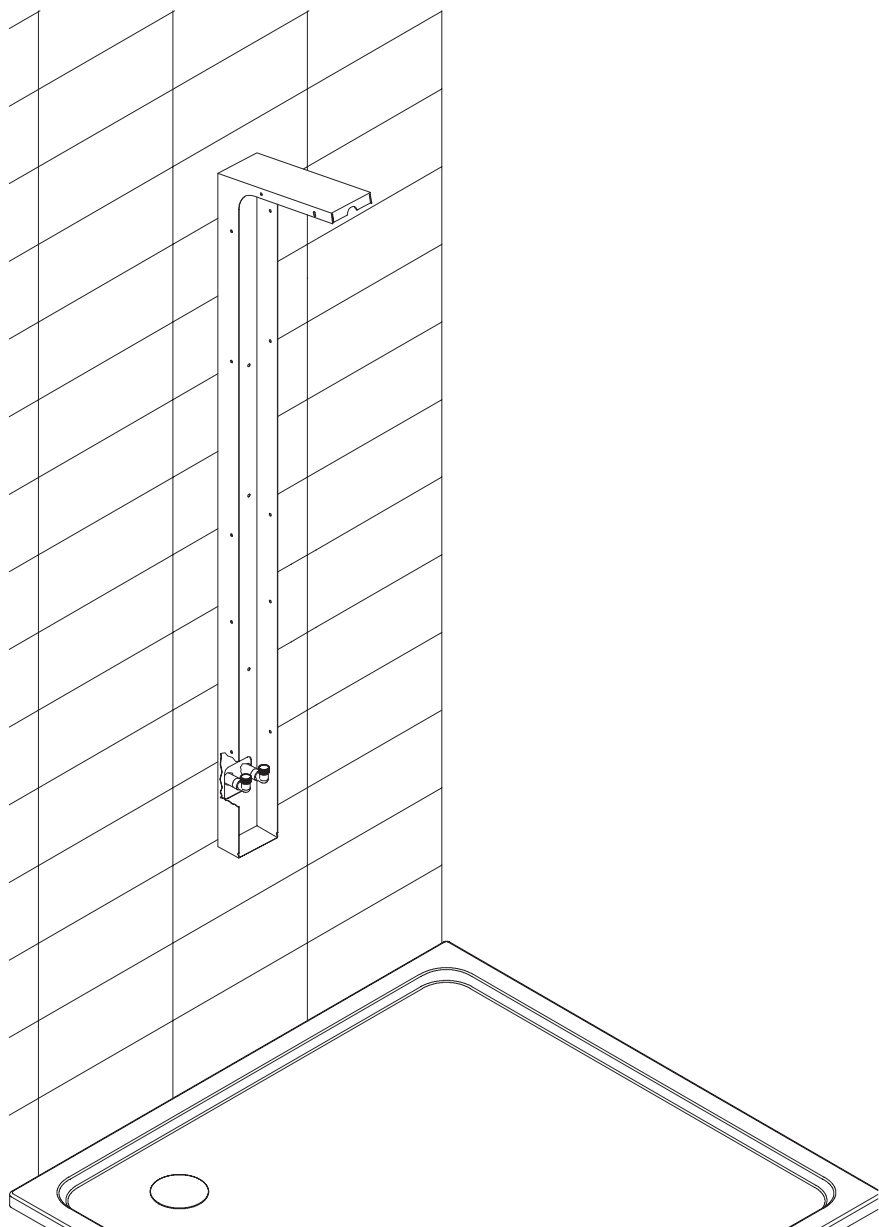

g

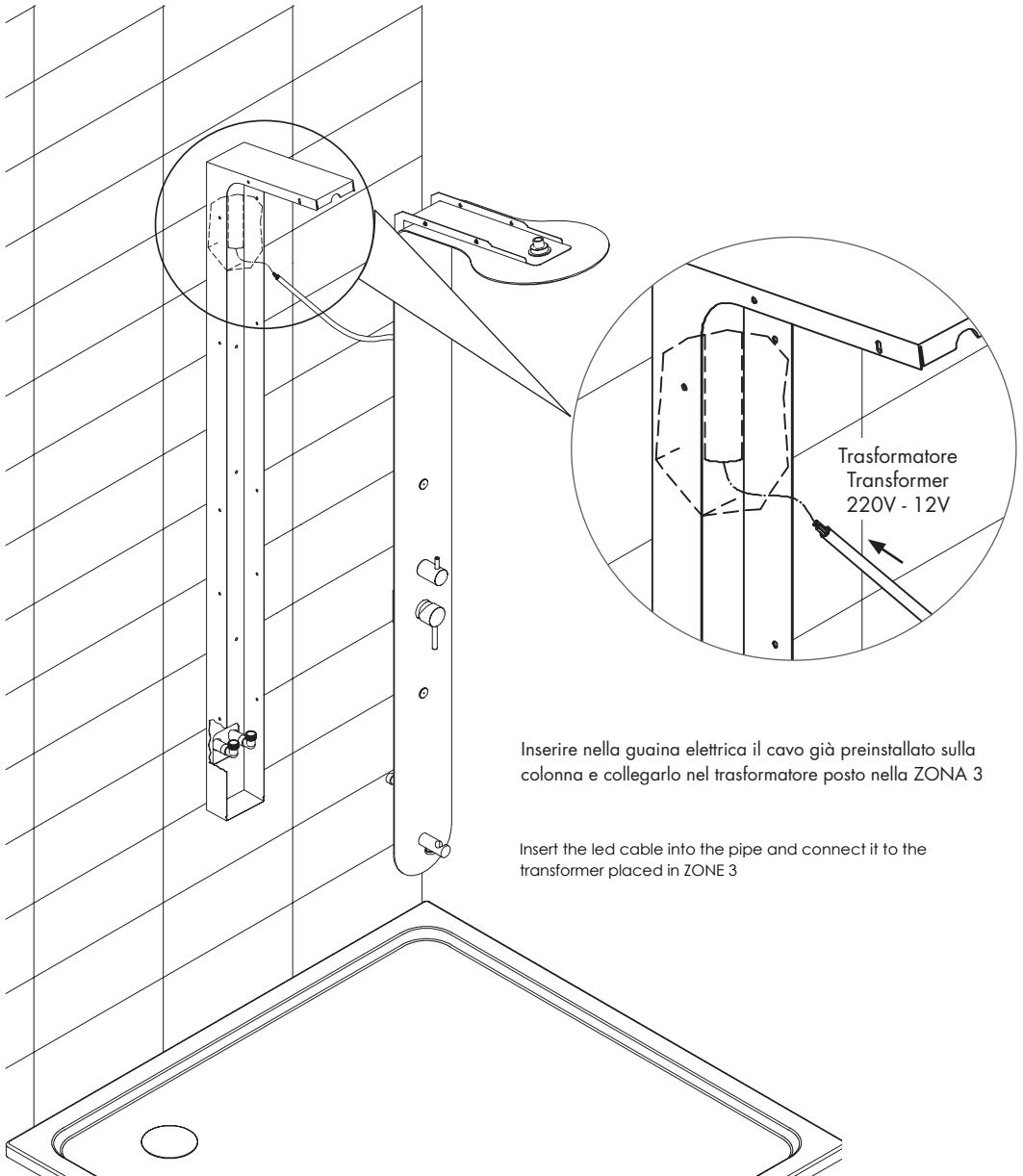

Inserire nella guaina elettrica il cavo già preinstallato sulla colonna e collegarlo nel trasformatore posto nella ZONA 3

Insert the led cable into the pipe and connect it to the transformer placed in ZONE 3

h

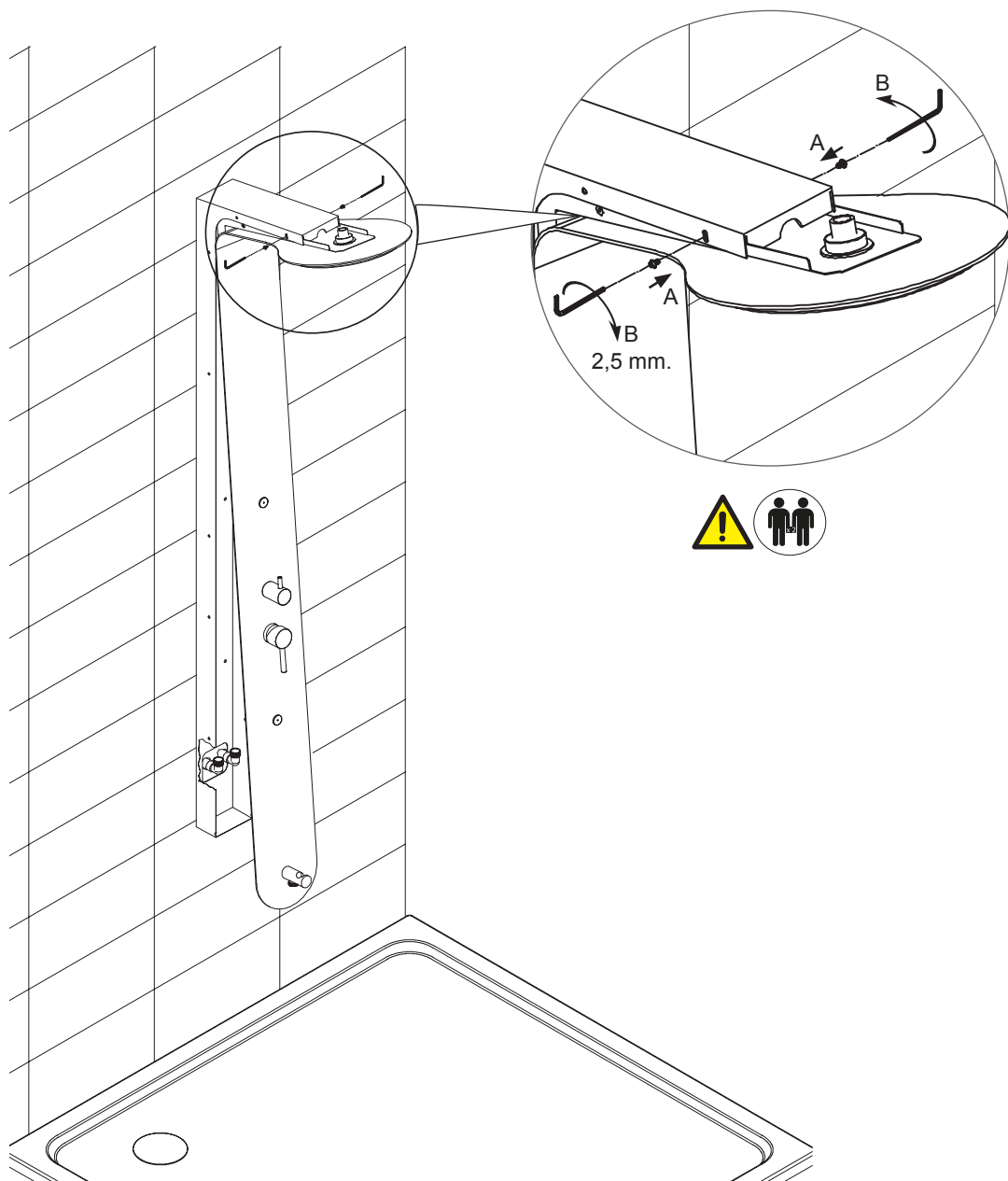

i

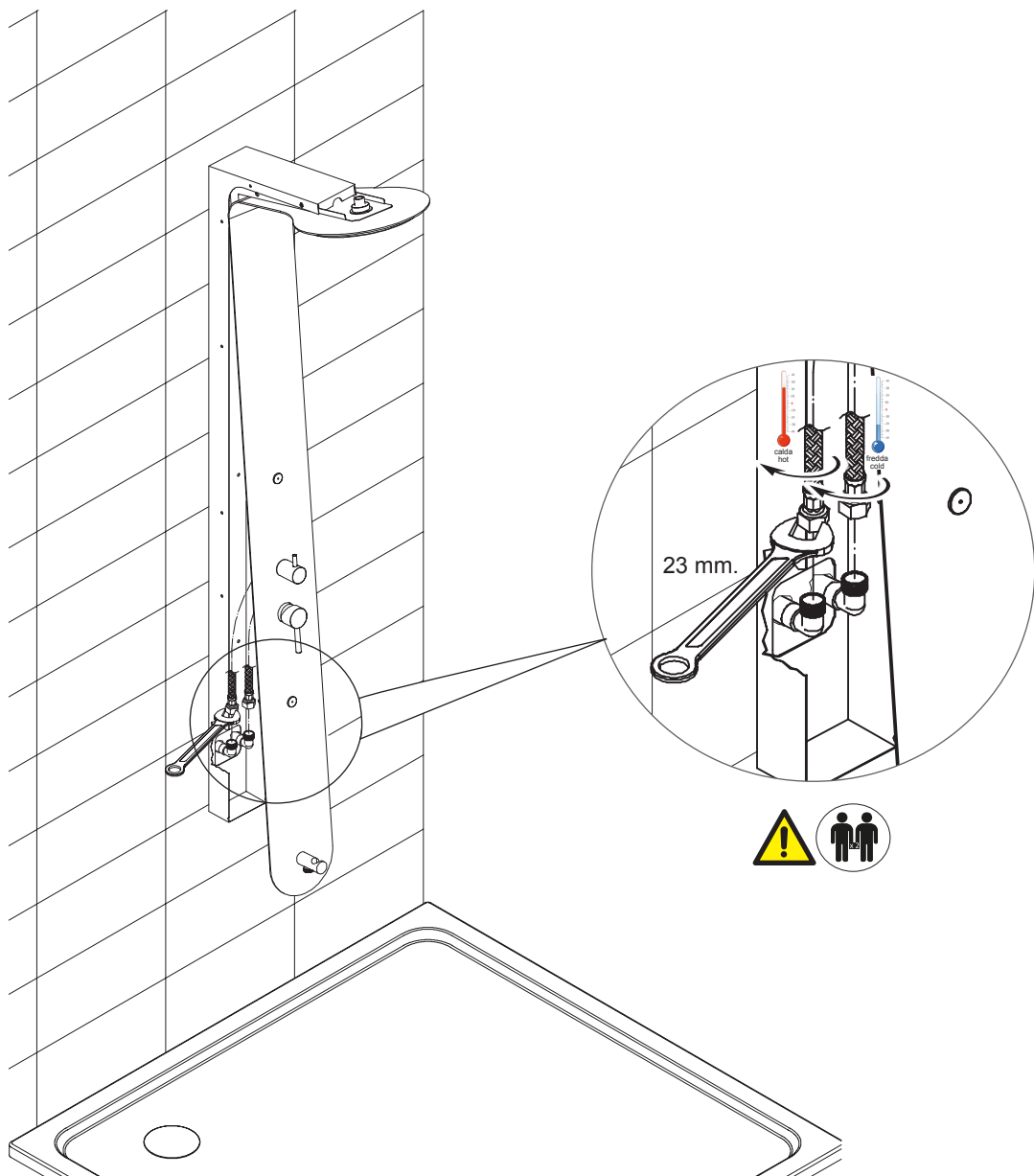

I

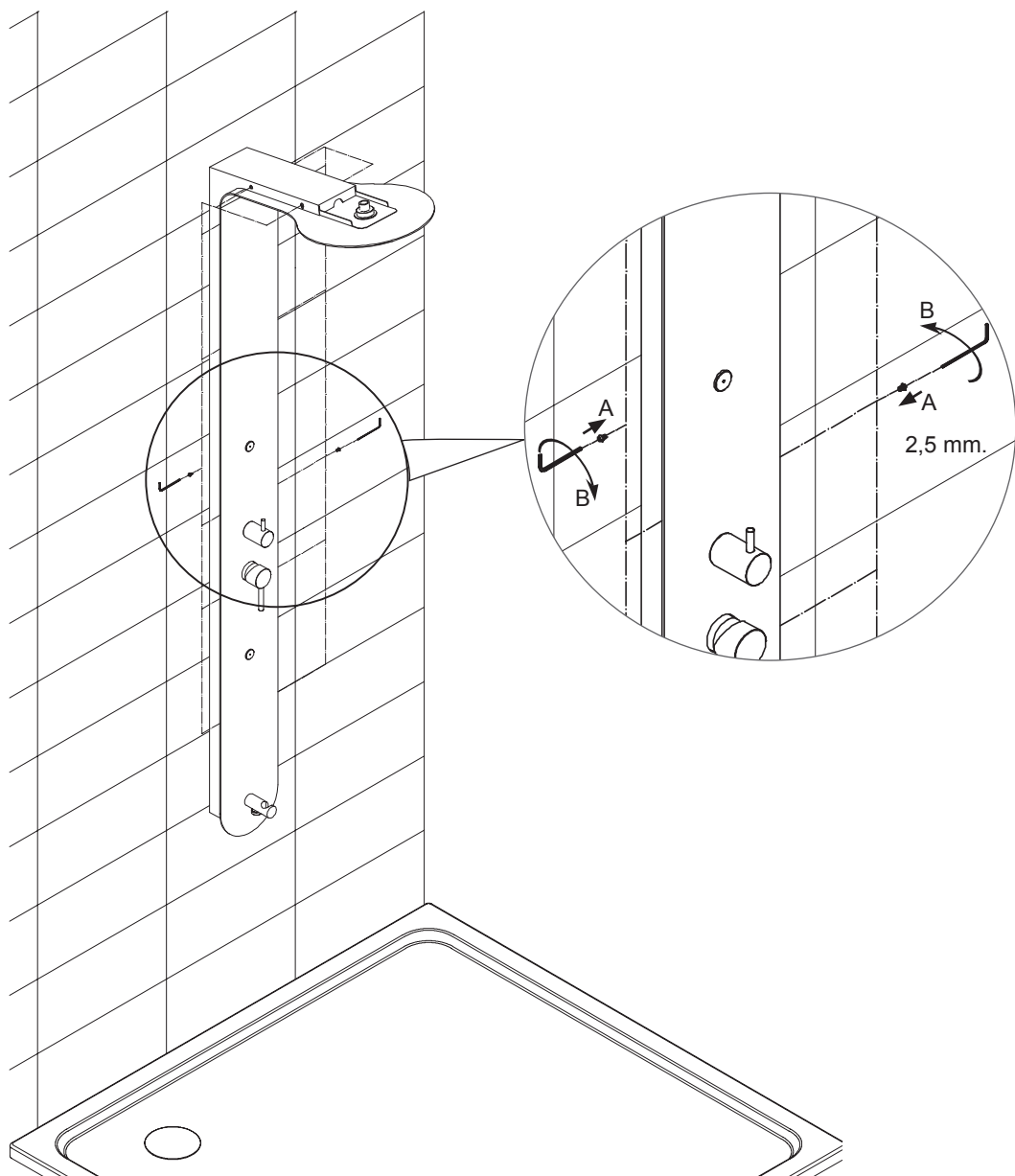

m

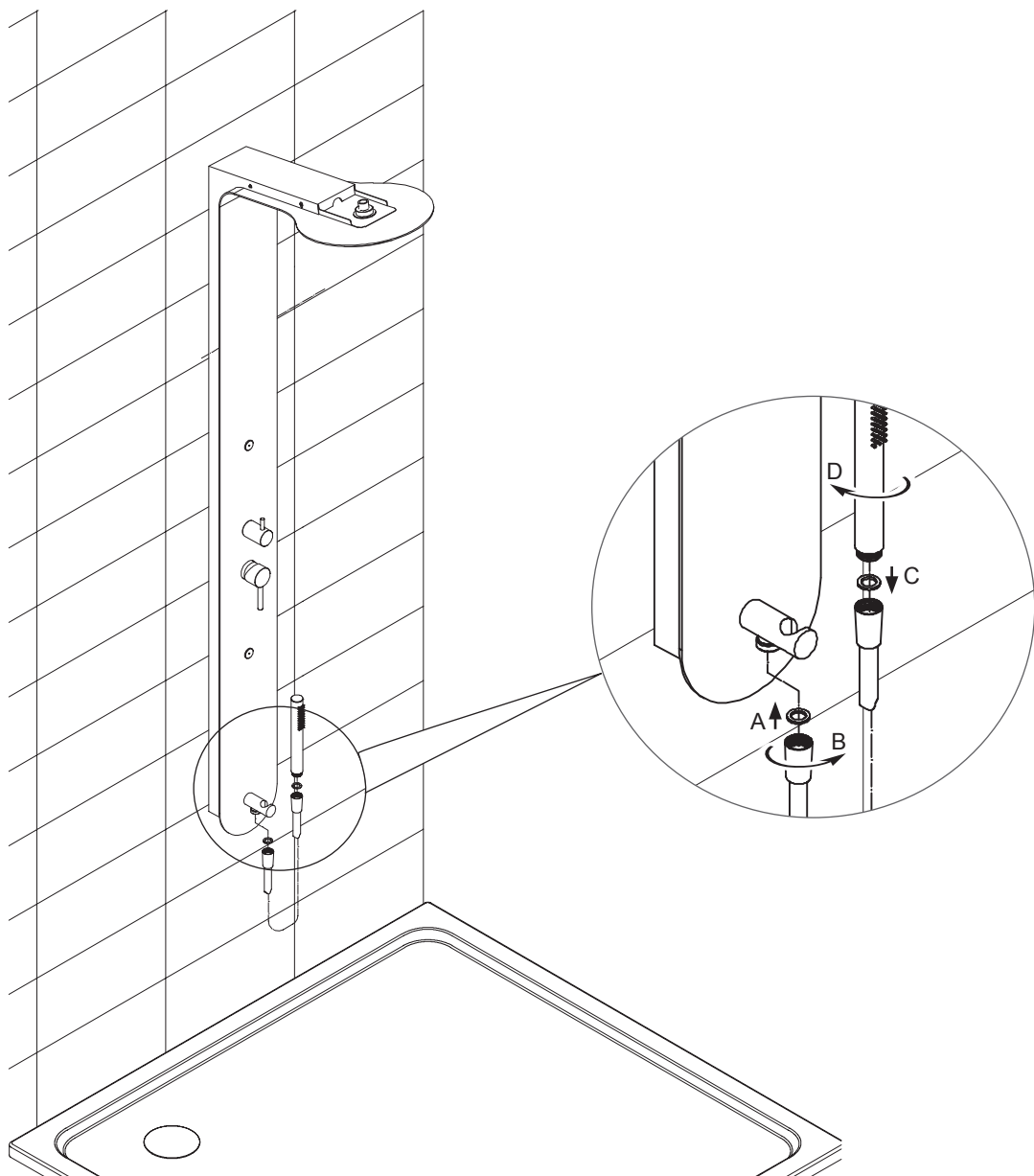

n

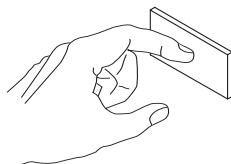
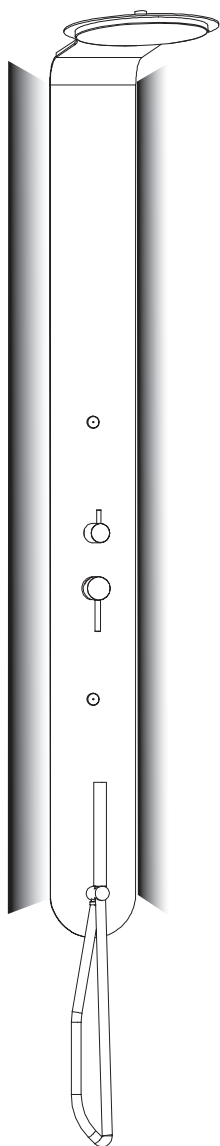

Interruttore on/off  
- ACCENSIONE LUCI -  
Control key on/off  
- LIGHT ON -



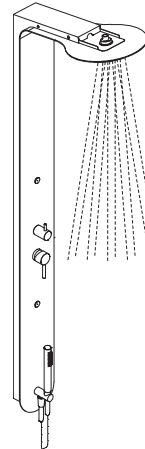
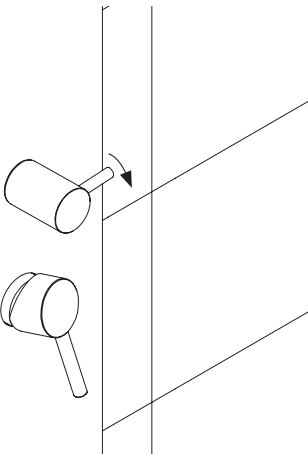
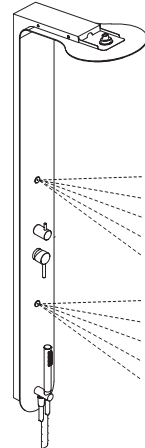
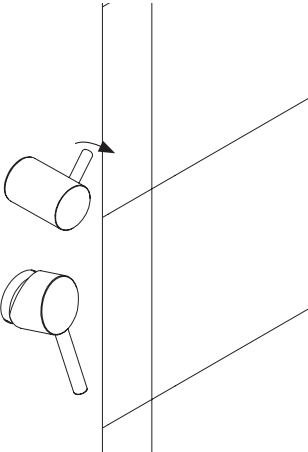
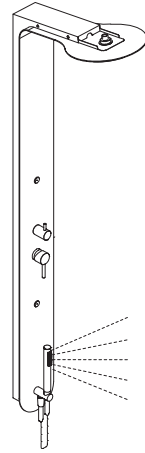
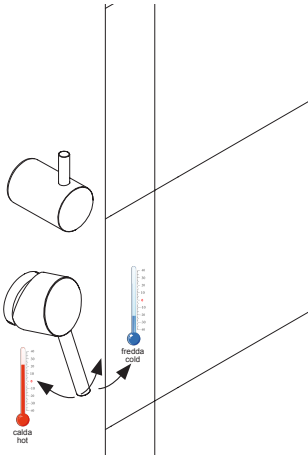

a

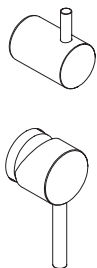

b

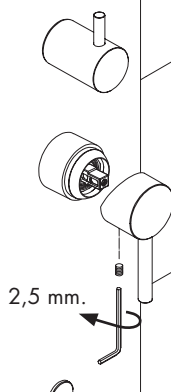

c

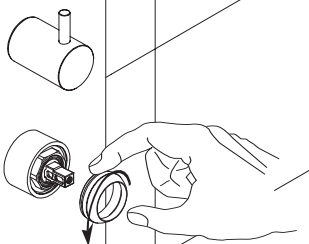

d

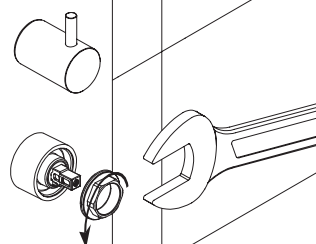

e

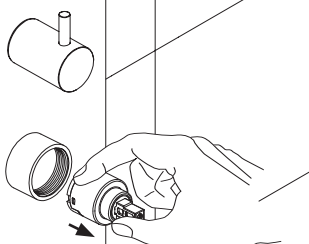

Rimontare seguendo il procedimento inverso (e-d-c-b-a)  
Replace following the instructions in reverse order (e-d-c-b-a)

a

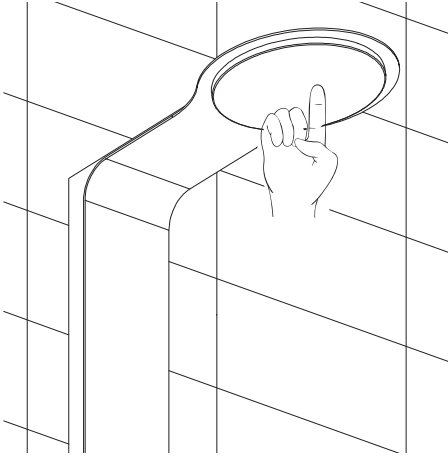

Per preservare la qualità del prodotto Aquaelite si raccomanda di pulire le superfici in finitura esclusivamente con acqua e sapone neutro asciugandole con un panno morbido.

Non utilizzare detergenti o detersivi abrasivi o contenenti alcool, acidi, candeggina, cloro, solventi chimici, spugne abrasive, paglie metalliche, etc.

L'acqua contiene calcare in quantità variabili, il quale può depositarsi sulla superficie del prodotto formando macchie e depositi. E' possibile evitare la formazione di macchie di calcare pulendo ed asciugando il prodotto dopo ogni utilizzo.

Per evitare la formazione di calcare sugli ugelli strofinarli periodicamente con un panno umido.

In order to maintain the quality of Aquaelite products, surfaces must be cleaned exclusively using soapy water and dried with a soft cloth. Never use detergents, powders or creams containing alcohol, acid, bleach, solvents, chemical agents, metal or abrasive sponges, etc.

Water contains limestone in variable quantity, which can remain on the surfaces leaving spots and forming deposits.

In order to avoid limestone deposits clean and dry the product immediately after use. It is possible to prevent limestone deposits on nozzles by regularly rubbing with a damp cloth.

**Dati tecnici generali per l'impianto idraulico**

Pressione minima di esercizio: 1,5 bar  
 Pressione di esercizio: campo di impiego ottimale consigliato  
 2,5 – 4 bar  
 Pressione massima di esercizio: 5 bar  
 (Per pressioni idrauliche superiori si consiglia l'utilizzo di un riduttore di pressione)  
 Temperatura massima di esercizio: 65 C°

**Funzionamento minimo:**

Getto a pioggia: 10 l/min. – 1,5 bar  
 Getto nebulizzato: 4-5 l/min. – 2 bar  
 Getto doccia: 9 l/min. – 2 bar

**Funzionamento ottimale:**

Getto a pioggia: 12 l/min. – 2,5 bar  
 Getto nebulizzato: 6 l/min. – 2,5 bar  
 Getto doccia: 9 l/min. – 2,5 bar

**PROTEZIONE AMBIENTALE**

I dispositivi elettrici ed elettronici non devono essere considerati rifiuti domestici. I consumatori sono obbligati dalla legge a restituire i dispositivi elettrici ed elettronici alla fine della loro vita utile ai punti di raccolta collettivi preposti per questo scopo o nei punti vendita.

**Technical information for the hydraulic system**

Minimum operating pressure: 1,5 bar  
 Operating Pressure: Optimal recommended use 2.5- 4 bar  
 Maximum operating pressure: 5 bar  
 (for higher hydraulic pressure it is recommended a pressure reducer)  
 Maximum operating temperature: 65 C°

**Minimum supply required:**

Rain function: 10 l/min – 1.5 bar  
 Mist spray function: 4-5 l/min – 2 bar  
 Handshower function: 9 l/min – 2 bar

**Optimal supply:**

Rain function: 12 l/min – 2.5 bar  
 Mist spray function: 6 l/min – 2.5 bar  
 Handshower function: 9 l/min – 2.5 bar

**ENVIRONMENTAL PROTECTION**

Electrical and electronic equipment is not to be treated as domestic refuse. Consumers are obliged by law to dispose of no-longer useful electrical and electronic equipment at the appropriate collection or sales points.

A series of horizontal dashed lines for writing notes.

A series of horizontal dashed lines for writing, consisting of 20 lines spaced evenly down the page.

A series of horizontal dashed lines for writing notes.



AQUA<sub>h</sub>elite

Aquaelite | Anpa Srl

Viale dello Sport, 16/18, 21026 Gavirate - VA - Italy

T.+39 0332 732906 | F. +39 0332 735819 | [www.aquaelite.it](http://www.aquaelite.it) | [info@aquaelite.it](mailto:info@aquaelite.it)